

**Significant Risks:**

This map is reproduced from Ordnance Survey material with the permission of Ordnance Survey on behalf of the Controller of Her Majesty's Stationary Office © Crown Copyright. Unauthorised reproduction infringes Crown copyright and may lead to prosecution or civil proceedings. Cardiff Council, LA09005L, 2001.

**MAIN LIBRARY ENTRANCE VIA CAR PARK**

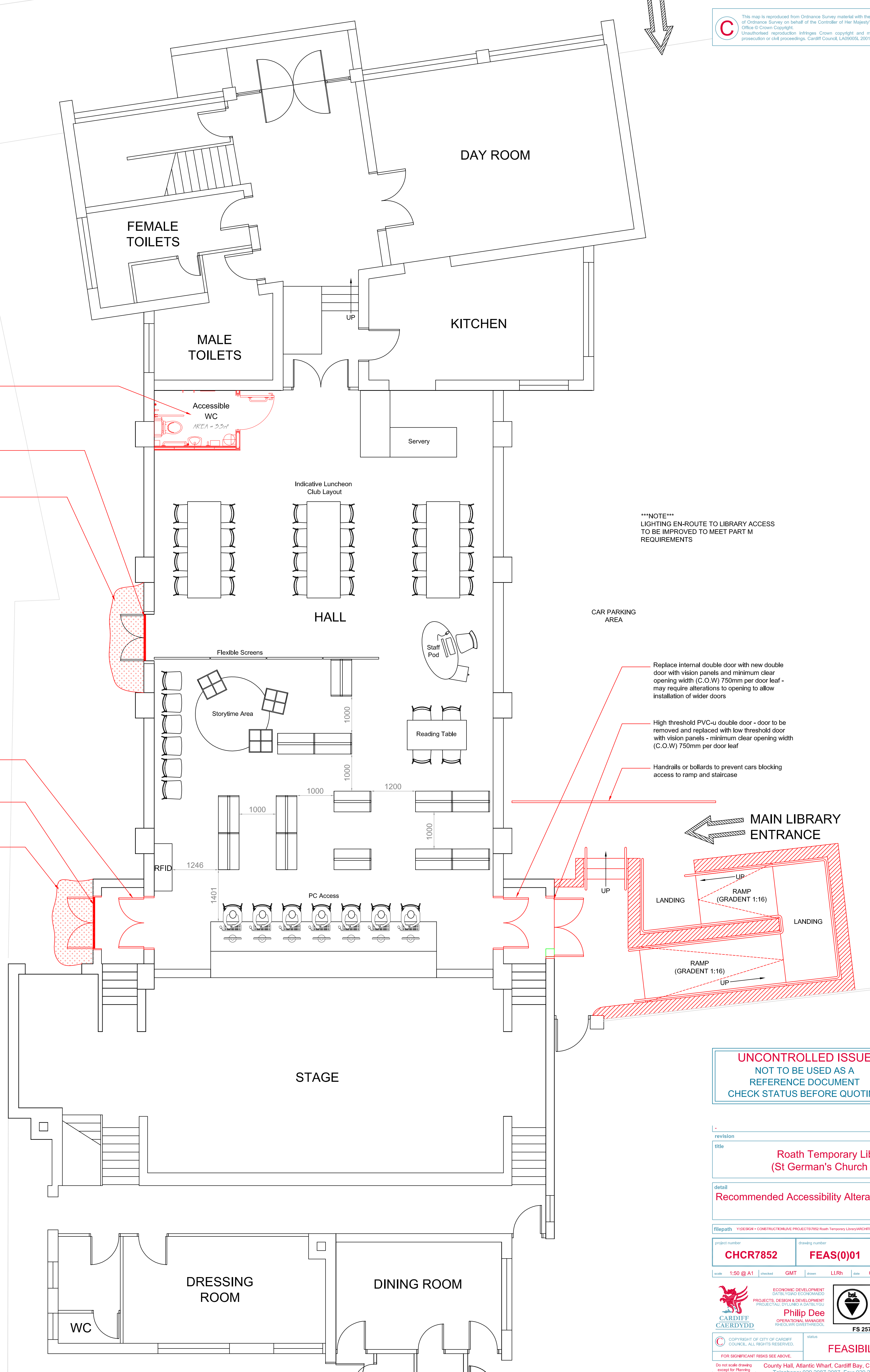

New accessible WC

High threshold PVC-u double door - door to be removed and replaced with low threshold door

Localised re-levelling works including installation of slot drainage system to prevent water ingress due to removal of high threshold.

Replace internal double door with new double door with vision panels and minimum clear opening width (C.O.W) 750mm per door leaf - may require alterations to opening to allow installation of wider doors

High threshold PVC-u double door - door to be removed and replaced with low threshold door.

Localised re-levelling works including installation of slot drainage system to prevent water ingress due to removal of high threshold.

\*\*\*NOTE\*\*\*  
LIGHTING EN-ROUTE TO LIBRARY ACCESS TO BE IMPROVED TO MEET PART M REQUIREMENTS

Replace internal double door with new double door with vision panels and minimum clear opening width (C.O.W) 750mm per door leaf - may require alterations to opening to allow installation of wider doors

High threshold PVC-u double door - door to be removed and replaced with low threshold door with vision panels - minimum clear opening width (C.O.W) 750mm per door leaf

Handrails or bollards to prevent cars blocking access to ramp and staircase

**UNCONTROLLED ISSUE**  
NOT TO BE USED AS A REFERENCE DOCUMENT  
CHECK STATUS BEFORE QUOTING

revision	title
	<b>Roath Temporary Library (St German's Church Hall)</b>
	<b>Recommended Accessibility Alterations</b>
filepath Y25E804 - CONSTRUCTION/PLANNING/PROJECTS/0952 Roath Temporary Library/ARCHITECTS/changes	
project number	drawing number
<b>CHCR7852</b>	<b>FEAS(0)01</b>
revision	<b>A</b>
scale	1:50 @ A1
checked	GMT
drawn	LLRh
date	09/12/2014
<b>Philip Dee</b> OPERATIONAL MANAGER RHEOLWR GWETHREDDOL	
<b>FS 25745</b>	
<b>FEASIBILITY</b>	
Do not scale drawing except for Planning Application purposes	
County Hall, Atlantic Wharf, Cardiff Bay, CF10 4UW Telephone: 029 2087 2087 Fax: 029 2087 2086	